

PARTS LIST: 500# POSITIONER

PART#	DESCRIPTION	QTY. REQ'D.
3205	OUTSIDE FACE PL.	1
3206	FACE PL.	1
3207	INTERNAL ROTATING PL.	1
3208	FACE PL. MOUNTING BLOCK	1
3209	GEAR BOX MOUNTING PL.	1
3210	BASE PL. ASSEMBLY	1
7027	1/4 H.P. D.C. MOTOR	1
8011	GEAR BOX	1

NOTE: SOME PARTS ARE ONLY AVAILABLE AS A COMPLETE ASSEMBLY.
 SOME PARTS ARE NOT SERVICEABLE OR REPLACEABLE IN FIELD AND MUST BE DONE AT THE FACTORY.
 FOR REPLACEMENT PARTS CALL CAPITOL WELDERS SUPPLY OR YOUR LOCAL DISTRIBUTOR FOR AGM PRODUCTS.

THIS DRAWING AND ALL INFORMATION CONTAINED HEREIN ARE PROPERTY OF A.G.M. INC. AND MAY NOT BE COPIED OR USED IN ANY WAY DETRIMENTAL TO AGM INC. INTERESTS.

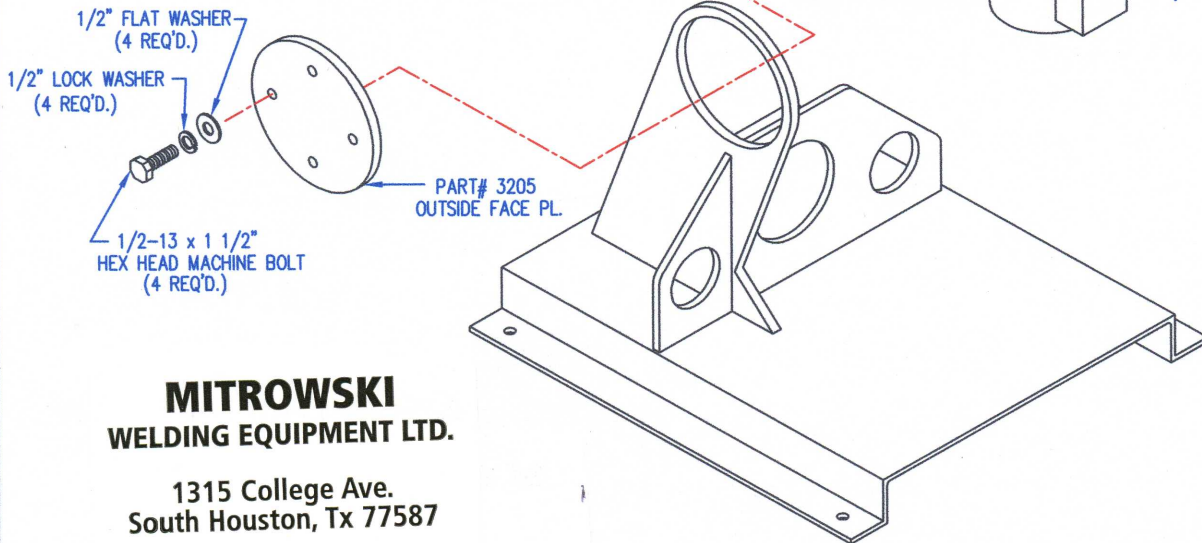
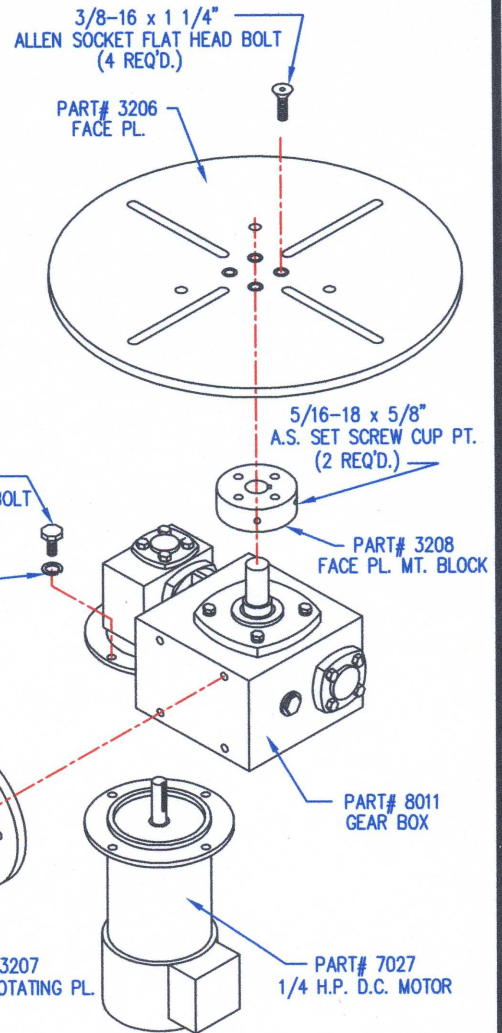

**MITROWSKI
 WELDING EQUIPMENT LTD.**

1315 College Ave.
 South Houston, Tx 77587

713-943-8032
 800-218-9620

DWG. NO.

DWG-0055

DATE:

5/2/02